

CARLISLE CITY COUNCIL

Report to:- **THE MAYOR AND MEMBERS OF THE CITY COUNCIL**

Date of Meeting:- **5th MARCH, 2002**

Agenda Item No:-

Public	Operational	Delegated No
<hr/>		
Accompanying Comments and Statements		
Environmental Impact Statement:		Required Included
		No No
Corporate Management Team Comments:		No No
City Treasurers Comments:		No No
City Solicitor & Secretary Comments:		No No
Head of Personnel Services Comments:		No No

Title:- **REVIEW OF PARISH BOUNDARIES AND ELECTORAL ARRANGEMENTS**

Report of:- **TOWN CLERK AND CHIEF EXECUTIVE**

Report reference:- **TC 47/02**

Summary:-

Draft Recommendations for changes to parish boundaries and electoral arrangements were published in September 2001 and representations invited from interested parties by mid-November. This Report reviews the Draft Recommendations in the light of representations received and puts forward Final Recommendations for submission to the Secretary of State or implementation by the Council, as appropriate.

Contact Officer: David Mitchell

Ext: 7029

NOTE: In compliance with Section 100D of the Local Government (Access to Information) Act 1985, the Report has been prepared in part from the following papers:-

Local Government and Rating Act 1997

Local Government Act 1972

Circular 11/97 from the Department of the Environment, Transport and the Regions

Summary of Recommendations:-

It is recommended that the following proposals be published as the Council's Final Recommendations in respect of the parish review and either referred to the Secretary of State for approval or implemented by the Council as appropriate (recommendations in **bold** indicate a modification to the Draft Recommendation) :

Recommendations which require the consent of the Secretary of State

- 1 Geltsdale parish be abolished and its area be incorporated into Castle Carrock parish (page 12);
- 2 the boundaries between of St. Cuthbert Without and Wetheral parishes (and corresponding ward and electoral division boundaries) be altered to transfer the whole of Carleton Grange to St. Cuthbert Without parish (page 15);
- 3 Vallum ward of Stanwix Rural parish become unparished and the number of Stanwix Rural parish councillors be reduced from 15 to 12 (page 19);
- 4 Windsor Park be excluded from Stanwix Rural parish and parish, ward and electoral division boundaries in the area be altered accordingly (page 20);
- 5 the boundaries between Rockcliffe and Stanwix Rural parishes (and corresponding ward and electoral division boundaries) be altered to transfer the whole of Harker Park to Rockcliffe parish (page 21);
- 6 the detached part of Kingmoor parish be transferred to Stanwix Rural parish (page 21);

Recommendations which do not require the approval of the Secretary of State

- 7 the boundaries of Askerton parish remain unchanged and no parish council be established (page 11);
- 8 **the boundary between Wetheral Parish and Botcherby Ward in the vicinity of the Limes estate, Durranhill Road remain unchanged** (page 16);
- 9 Carlatten and Cumrew be grouped under a common parish council; the number of Councillors for each parish be 2 for Carlatten and 4 for Cumrew; the first election for the common parish council be held on the ordinary day of election in May 2002; the initial term of office of Parish Councillors be two years; and elections be held in 2004 and every fourth year thereafter. (pages 12 and 25);

- 10 the number of Councillors for Midgeholme be reduced from 9 to 5 with effect from the next scheduled election in the parish in 2003 (pages 14 and 25);
- 11 the electoral arrangements for Hayton parish be revised in accordance with the scheme favoured by Hayton parish council with effect from the next scheduled election in the parish in 2004 (pages 23 and 25);
- 12 statutory Orders be made under the relevant sections of the Local Government Act 1972 and the Local Government and Rating Act 1997 to give effect to Recommendations 9 - 11;
- 13 no changes be made to the boundaries or electoral arrangements of any other parish.

Summary of Final Recommendations by Parish

Arthuret	-	no change	(para 74)
Askerton	-	no change	(para 20)
Beaumont	-	no change	(para 74)
Bewcastle	-	no change	(para 20)
Brampton	-	no change	(para 74)
Burgh-by-Sands	-	no change	(para 74)
Burtholme	-	no change	(para 35)
Carlatton	-	group with Cumrew	(para 23)
Castle Carrock	-	enlarge to incorporate Geltsdale	(para 25)
Cummersdale	-	no change	(para 11)
Cumrew	-	group with Carlatton	(para 23)
Cumwhitton	-	no change	(para 23)
Dalston	-	no change	(para 74)
Denton Nether	-	no change	(para 74)
Denton Upper	-	no change	(para 35)
Farlam	-	no change	(para 35)
Geltsdale	-	abolish and incorporate area into Castle Carrock	(para 25)
Hayton	-	alter electoral arrangements	(para 81)
Hethersgill	-	no change	(para 74)
Irthington	-	no change	(para 74)
Kingmoor	-	transfer detached part to Stanwix Rural parish	(para 70)
Kingwater	-	no change	(para 35)
Kirkandrews	-	no change	(para 74)
Kirklington Middle	-	no change	(para 76)
Midgeholme	-	alter electoral arrangements	(para 29)
Nicholforest	-	no change	(para 74)
Orton	-	no change	(para 11)
Rockcliffe	-	enlarge to incorporate whole of Harker Park	(para 68)
Scaleby	-	no change	(para 85)
Solport	-	no change	(para 35)
Stanwix Rural	-	abolish Vallum Ward	(para 59)
	-	alter boundary to exclude Windsor Park from the parish	(para 63)
	-	transfer Harker Park to Rockcliffe	(para 68)
	-	alter electoral arrangements	(para 55)
Stapleton	-	no change	(para 20)
St. Cuthbert Without	-	enlarge to incorporate part of Wetheral and part of Harraby ward	(para 41)
Walton	-	no change	(para 74)
Waterhead	-	no change	(para 35)
Westlinton	-	no change	(para 74)
Wetheral	-	transfer part to St. Cuthbert Without	(para 41)
	-	no change to boundary with Botcherby ward	(para 47)

INTRODUCTION

- 1 At the City Council meeting on 11th September, 2001, draft recommendations arising from the Council's review of parish boundaries and electoral arrangements were approved for public consultation. Notice of publication of the draft recommendations was published in the local press and parish councils and other interested parties were invited to submit representations by mid-November 2001.
- 2 The Draft Recommendations had been prepared following preliminary consultations with parish councils and some additional specific consultations requested by the City Council. This Report reconsiders the Draft Recommendations in the light of further representations received and puts forward final proposals to be implemented by the Council or referred, as appropriate, to the Secretary of State for approval.
- 3 The statutory powers in respect of parish reviews are set out in Appendix 1 and the review procedure is outlined in Appendix 2.
- 4 When assessing whether changes to existing parish arrangements are desirable, the Council must observe the requirement of the Local Government and Rating Act 1997 (Section 22) to have

“regard to the need

(a) to reflect the identities and interests of local communities, and

(b) to secure effective and convenient local government.”
- 5 The Council must also have regard to any guidance issued by the Secretary of State. The most recent guidance, DETR Circular 11/97, stresses the importance of the feeling of local community and the wishes of local inhabitants when defining parishes.

CURRENT PARISH ARRANGEMENTS

- 6 Map 1 shows the existing pattern of parishes, together with the rural City ward boundaries. The parished part of the City comprises 37 parishes, 33 having parish councils, 3 being administered by parish meeting and one (Geltsdale) currently with no electors. The parishes vary considerably in size by both area and population, reflecting local circumstances. Parishes or wards of parishes are also used as the building-blocks to define rural City wards and County electoral divisions. The electorates, number of parish councillors for each parish and the number of electors per councillor are set out in the following Table.

Parish Electorates and Number of Councillors

2000/2001

<u>Parish</u>	<u>Electorate</u>	<u>Number of Councillors</u>	<u>Number of Electors per Councillor</u>
Arthuret	1902	15	126
Askerton	118	-	-
Beaumont	374	9	41
Bewcastle	335	9	37
Brampton	3333	15	222
Burgh-by-Sands	882	10	88
Burtholme	146	7	20
Carlatton	27	-	-
Castle Carrock	235	7	33
Cummersdale	406	9	45
Cumrew	66	-	-
Cumwhitton	253	8	31
Dalston	2064	15	137
Denton Nether	262	7	37
Denton Upper	73	5	14
Farlam	495	11	45
Geltsdale	0	-	-
Hayton	1783	11	162
Hethersgill	300	9	33
Irthington	602	10	60
Kingmoor	330	8	41
Kingwater	136	7	19
Kirkandrews	364	12	30
Kirklington Middle	285	8	35
Midgeholme	47	9	5
Nicholforest	312	8	39
Orton	310	8	38
Rockcliffe	601	9	66
Scaleby	262	8	33
Solport	140	5	28
Stanwix Rural	2356	15	157
Stapleton	189	7	27
St. Cuthbert Without	1551	15	103
Walton	240	8	30
Waterhead	96	7	14
Westlinton	291	8	36
Wetheral	4159	15	277
TOTAL	25325	314	

INITIAL REPRESENTATIONS AND CONSULTATIONS

- 7 The current review commenced in June 2000 when the start of the review was announced by press notice and representations were invited from parish councils, the County Council, the Carlisle Parish Council's Association and the Cumbria Local Councils Association.
- 8 Initial representations proposed the following changes:
 - (a) abolition of Askerton parish and incorporation of its area into Bewcastle and Stapleton parishes;
 - (b) alteration of Stanwix Rural parish boundary to exclude the Lansdowne portion from the parish;
 - (c) realignment of boundary between Stanwix Rural and Rockcliffe parishes to incorporate whole of Harker Park in Stanwix Rural parish;
 - (d) transfer of properties in vicinity of Humphries House Lonning from Kirkclinton to Scaleby parish;
 - (e) alteration to electoral arrangements of Hayton parish;
 - (f) transfer of properties in the Broomhills and Newby West areas from Cummersdale to Orton parish;
 - (g) possible amalgamation of Carlattan and Cumrew parishes or incorporation into neighbouring parishes;
 - (h) possible amalgamation of Waterhead and Upper Denton parishes.
- 9 In addition to the need to address these specific requests for alterations to existing parish arrangements, four general issues emerged from consideration of the initial representations and the statutory guidance:

(a) parishes with no parish council

Government guidance, set out in DETR Circular 11/97 (see Appendix 2) supports the establishment of parish councils. Those parishes which rely on government by parish meeting only may no longer be appropriate.

(b) small parishes with parish councils

Parishes with a parish council but an electorate below the statutory figure of 150 for the establishment of a parish council without District Council consent may no longer be large enough on their own to ensure effective and convenient local government.

(c) the impact of development at the fringes of the urban area of Carlisle

In recent years there has been significant new housing development in parished areas on the fringes of urban Carlisle. The residents of these new estates may not share the same community identity and interests as the rest of the parish.

(d) parishing of the unparished urban area.

Carlisle Parish Councils Association raised this issue when initially consulted on the review. Although they were not aware of any requests by residents or local groups seeking establishment of new parish councils, the Association considered that the matter should be debated within the context of the current review. The legal framework for establishment of parish councils applies equally in urban areas as it does in a rural context. Circular 11/97, however, points to the problem of identifying the community upon which a parish might be based in an urban area.

At a meeting between the Executive and representatives of Parish Councils in December 2001, the Leader of the Council confirmed that there appeared to be no demand or interest from communities in the urban area for achieving Parish Council status and that there were provisions in the New Constitution to introduce Area working and Area Forums if needed at some point in the future. He indicated that the City Council would monitor the level of interest in the urban area. In any event, in the absence of a recommendation by a local authority to create a parish, there is provision under the 1997 Act for local residents to petition the Secretary of State for the creation of new parishes in a currently unparished area.

The Final Recommendations proposed in this Report can be implemented without prejudicing any future decisions which might be taken in respect of unparished urban Carlisle.

10 Before considering issues (a) to (c) above and preparing draft recommendations, the Council decided at the end of 2000 that some further specific consultations should be carried out:

- (a) electors in parishes without a parish council be consulted on the options for future arrangements in those parishes;
- (b) City Councillors representing wards whose boundaries would be affected by any suggested parish boundary change be consulted on such proposals;

- (c) electors in the following areas be consulted on whether they wished to remain parished:

Whiteclosegate portion of Vallum ward of Stanwix Rural parish;
Windsor Park estate (extension of Windsor Way);
Carleton Grange estate (off Garlands Road);
The Limes, Durranhill Road.

- (d) electors affected by suggested boundary changes between the following parishes be consulted on the proposals:

Stanwix Rural/Rockcliffe/Kingmoor;
Kirklington/Scaleby

- 11 The Council also agreed at that stage that an alteration to the boundary between Orton and Cummersdale parishes, proposed by Orton Parish Council, was premature having regard to the development plans for the south west of the City and the Northern Development Route.
- 12 The Draft Recommendations were prepared following consideration of the results of these additional consultations, as set out in Report TC 181/01. The representations received in response to the Draft Recommendations are attached as Appendix 3. A copy of the Draft Recommendations was also sent to Cumbria County Council. Following discussion by the County Council Local Committee for Carlisle and the County Council Cabinet in November 2001, it was agreed that any County Councillors who wished to make representations should do so on an individual basis. No further comments have been received from County members for electoral divisions within the City Council's area.
- 13 The Draft Recommendations are reviewed in turn below in the light of the further comments received.

REVIEW OF THE DRAFT RECOMMENDATIONS

Parishes without a Parish Council

- 14 The three parishes which do not have parish councils and are administered by parish meeting are Askerton, Carlatton and Cumrew. (Parishes without parish councils must have at least two parish meetings of electors each year).

Askerton

Draft Recommendation

The boundaries of Askerton parish remain unchanged and no parish council be established.

- 15 Askerton has a scattered electorate of 118. The only small centre of population is Kirkcambeck in the south of the parish but there is no obvious centre of community identity. There have been no parish meetings in recent years. Neighbouring Bewcastle parish council had requested an enlargement of its area to incorporate properties in the Shopford area of Askerton parish which are close to the hamlet of Bewcastle. Residents of the properties concerned had indicated to Bewcastle parish council that they would prefer to be in that parish. If such a boundary change were made, however, the remaining part of Askerton would be even less viable as an independent unit.
- 16 Kingwater parish council would be agreeable to a re-alignment of its boundary to include the Kirkcambeck portion of Askerton and Stapleton parish council would accept the transfer of the western part of Askerton, subject to the agreement of the residents concerned. Map 2 illustrates the possible 3-way division of Askerton.
- 17 An alteration to the boundaries between Askerton, Kingwater and Bewcastle would involve a corresponding re-alignment of the boundary between Irthing and Lyne wards of the City and the Brampton & Gilsland and Longtown & Bewcastle electoral divisions of the County.
- 18 All electors in Askerton were asked for their views on abolition of the parish. 77% replied and of those 93% wish to retain the parish and only 7% favoured its division and incorporation into neighbouring parishes. Many respondents added comments strongly objecting to the possible disappearance of the parish. In response to the suggestion that the parish should be abolished, two parish meetings were also held to discuss the matter.

- 19 The consensus was that the parish has a long history, a distinctive heritage and a sense of identity which should not be lost. The view was also taken that as the parish had no communal facilities such as a village hall or playing fields and raises no parish precept there was no need for a parish council to be established. (Only parishes with more than 200 electors must have a parish council.) Although no parish meetings had been held for a number of years, it was agreed to hold the statutory minimum of two per year.
- 20 The Draft Recommendation was made having regard to government advice which stresses the importance of local community feeling and the wishes of local inhabitants. **It is recommended that the Draft Recommendation be confirmed as the Council's Final Recommendation.**

Carlatton and Cumrew

Draft Recommendation

Carlatton and Cumrew be grouped under a common parish council and the number of Councillors for each parish be 2 for Carlatton and 4 for Cumrew, subject to the approval of parish meetings of both parishes. (Map 3)

- 21 The electorates of the adjoining parishes of Carlatton and Cumrew (27 and 66 respectively) fall well below the statutory guidelines for the establishment of parish councils. Residents were asked for their views on the options of grouping or amalgamating, either together or with either of the adjoining parishes of Castle Carrock or Cumwhitton (see Map 3). Both Castle Carrock and Cumwhitton parish councils had indicated that they would have no objection to enlargement to include Carlatton and/or Cumrew but felt that it was a matter which should not be imposed on the smaller parishes if they would rather stay independent.
- 22 56% of Carlatton electors responded to consultation and 60% of those favoured joining with Cumrew, 33% with Cumwhitton and 7% with Castle Carrock. Of the 38% of Cumrew electors who replied, 72% were in favour of joining with Carlatton while 28% preferred amalgamation with Castle Carrock. A number of respondents, while recognising community links with Castle Carrock or Cumwhitton, commented on the similarities between Carlatton and Cumrew and expressed a desire to retain a degree of independence. Most preferred grouping the parishes to amalgamation – under a grouping arrangement both parishes would continue to exist but with a common parish council; amalgamation involves abolishing existing parishes and creating a new parish and parish council.

- 23 The Draft Recommendation was put forward in order to reflect existing community identities and to take account of the wishes of local residents. At a joint parish meeting held on 13th November, 2001, both parishes formally approved the formation of a Parish Council and **it is recommended that the Draft Recommendation be confirmed as the Council's Final Recommendation.**

Geltsdale

Draft Recommendation

Geltsdale parish be abolished and its area be incorporated into Castle Carrock parish. (Map 4)

- 24 Geltsdale parish has no electors and serves no purpose as a local government unit. As it adjoins Castle Carrock parish and is linked to it by road, Castle Carrock would be the most appropriate parish with which Geltsdale could be amalgamated, as illustrated on Map 4.
- 25 **It is recommended that the Draft Recommendation be confirmed as the Council's Final Recommendation.**

Small Parishes with Parish Councils

- 26 There are six other parishes with less than 150 electors each, namely Burtholme, Denton Upper, Kingwater, Midgeholme, Solport and Waterhead. Each has a parish council.

Draft Recommendation

No change be made to the boundaries of Burtholme, Upper Denton, Kingwater, Midgeholme, Solport and Waterhead parishes and the number of Councillors for Midgeholme be reduced from 9 to 5.

Burtholme

- 27 Burtholme is a compact parish whose 146 electors are concentrated in the village of Lanercost and the hamlet of Banks. It is separated from neighbouring parishes by the identifiable boundaries of the River Irthing to the south and Mill Beck to the west and north. The Parish Council has not commented on the review.

Kingwater

- 28 Kingwater parish has a widely scattered electorate of 136. As indicated in paragraph 14 above, the parish council would be agreeable to enlargement to incorporate part of Askerton but otherwise has not requested any change to the current arrangements.

Midgeholme

- 29 Midgeholme parish has a very low electorate of 47, centred on the small settlement of Midgeholme. It is also considered to be over-represented with nine parish councillors, highlighted by difficulties in filling all the seats on the Parish Council at recent elections. Although no comments on the present review have been received from either Midgeholme or Farlam parish councils, amalgamation of these parishes has been discussed by them in the past. If Midgeholme were considered to be no longer viable, Farlam would be the appropriate parish with which it could be combined or grouped.

Solport

- 30 Solport has a scattered electorate of 140 and no centre of population. It is, however, clearly separated from adjoining parishes by the River Lyne to the east, Rae Burn to the south and west and uninhabited forestry land in the north. No comments have been received from the parish council and no other representations have been received to alter the parish boundaries.

Upper Denton

- 31 Upper Denton parish is small both in area and electorate (73) and, like the neighbouring parish of Waterhead, includes part of the village of Gilsland. Combination or grouping with Waterhead had been considered by Upper Denton parish council but they were very much in favour of both parishes remaining independent. Waterhead is much larger geographically and, Gilsland apart, has a more widely distributed population. Upper Denton is also physically separated from Waterhead by the River Irthing and from Nether Denton parish to the west by a stretch of largely uninhabited upland.
- 32 Waterhead parish council likewise wished to maintain the status quo. They took the view that important local issues, such as responding to consultation on the management of Hadrian's Wall which runs through the parish, were best represented by the local community.

Waterhead

- 33 Waterhead parish (electorate 96) is discussed in paragraphs 31 and 32 above.

- 34 Although these six parishes have small electorates, they nevertheless each reflect long-established individual communities who wish to continue as separate entities. A case could be made for the abolition of Midgeholme, having the second lowest parish electorate in the City (47), but it has a separate identity which may be lost if it were combined with the much larger neighbouring parish of Farlam.
- 35 In the absence of other evidence of a desire for change, the Draft Recommendation took account of the views of those parish councils which had submitted representations and also addressed the over-representation on Midgeholme Parish Council. **It is recommended that the Draft Recommendation be confirmed as the Council's Final Recommendation.**

Urban Fringe

Carleton Grange

Draft Recommendation

The boundaries of St. Cuthbert Without and Wetheral parishes (and corresponding ward and electoral division boundaries) be altered to transfer the whole of Carleton Grange estate to St. Cuthbert Without parish. (Map 5)

- 36 The Carleton Grange estate of over 400 dwellings, being developed on the south side of the City in the Garlands area, will on completion cross the boundaries of two parishes, (St. Cuthbert Without and Wetheral), three City wards (Harraby, Dalston and Wetheral) and three County electoral divisions (Harraby, Wetheral and Dalston & Cummersdale) - see Map 6. Although adjacent to urban Carlisle and partly in Harraby ward, there is no direct access by road from the estate to the rest of the ward; the entrance to the development is from Cumwhinton Road by way of the Garlands Road. The Wetheral part of the estate is separated from the rest of the parish by the M6 motorway.
- 37 St. Cuthbert Without parish council has not commented on the parish review. Wetheral parish council initially took the view that, although the part of the estate within its boundary has yet to be built, future residents may feel that they have no affiliation with the parish and identify with the urban area. While the parish council recognised that the M6 makes a good delineation between the parish and the urban centre, they said that the parish is under severe planning pressure and to the west of the motorway is green belt. As they are a consultee on the Local Plan which defines the green belt, they would wished to continue to be in a position to comment on development in this area. The parish council therefore wished to see no change to the parish boundary.

- 38 The 165 electors on the estate were asked for their views. Of the 75 (45%) who replied, 85% favoured staying in St. Cuthbert Without parish and 15% supported the area becoming unparished. A Councillor for Wetheral ward had no objection to the Wetheral part of the estate transferring to St. Cuthbert Without; a Harraby member supported transfer of the whole estate to St. Cuthbert Without, and Councillors for Dalston ward favoured the status quo.
- 39 In the interests of effective local government, it would be beneficial if the whole estate were either within one parish or completely unparished. A transfer of the parished areas to Harraby ward would eventually lead to an imbalance in electorate between Harraby and the other wards of the City. (Harraby currently has 4547 electors compared with the average for the urban wards of 4521). Incorporation of the estate into Wetheral parish and ward is not considered to be viable because of its physical separation from the rest of the parish.
- 40 The most satisfactory option would be to integrate the estate wholly within St. Cuthbert Without parish and Dalston ward. The consequent increase in the electorate of Dalston ward would serve to decrease the existing percentage variance of 11% between the number of electors per councillor for the ward (1355) and the average for the City as a whole (1525).
- 41 Having considered the draft recommendation, Wetheral Parish Council accepts transfer of that part of Carleton Grange within its parish to St. Cuthbert Without Parish and **it is recommended that the Draft Recommendation be confirmed as the Council's Final Recommendation.**

Durranhill Road Development

Draft Recommendation

The Limes development be excluded from Wetheral parish and the parish boundary (and corresponding ward and electoral division boundaries) be altered accordingly. (Map 7)

- 42 The Limes housing development on Durranhill Road is within the Scotby ward of Wetheral parish (see Map 7). It is still in course of construction but on completion will comprise about 100 properties. When first consulted, the parish council accepted that the residents may feel no affiliation with Scotby; they are some distance from the village and are outwith the school catchment area. However, for the same reasons as it favoured the status quo in respect of the Carleton Grange development (see paragraph 37 above), the parish council wished to see the parish boundary in the Durranhill area remain unchanged.

- 43 If the Limes were transferred out of the parish, it would also require an alteration to the boundaries between Wetheral and Botcherby wards of the City and Wetheral and Botcherby electoral divisions of the County.
- 44 There were only a relatively small number of electors on the estate but of the 85% who replied to consultation, 97% wished to remain in Wetheral parish and ward. Councillors representing both Wetheral and Botcherby wards felt that due to its urban character and location, it might be more appropriate if the estate were in Botcherby ward whose electorate of 4487 is below the urban ward average of 4521.
- 45 In formulating the Draft Recommendation, it was considered that having regard to its close proximity to urban Carlisle and in the absence of community ties with Scotby, the Limes development should be excluded from Wetheral parish.
- 46 In commenting on the Draft Recommendations, Wetheral Parish Council felt that greater account should be taken of the wishes of local residents who had clearly expressed a preference for remaining in the parish. It could also be argued that, unlike the Lansdowne and Windsor Park areas of Stanwix Rural parish (recommended for transfer out of the parish – see paragraphs 51 to 61 below), the Limes estate is not a direct extension of any existing residential development and the current boundary line of Durranhill Beck and Durranhill Road is therefore the appropriate one. On the other hand, the estate is near other recent new housing on the south side of Durranhill Road at Scotby Close/Scotby Gardens and is separated from the rest of Wetheral parish by open fields.
- 47 Having regard to the further representations from Wetheral Parish Council and the wishes of local residents, **it is recommended that the Draft Recommendation be withdrawn and the boundary between Wetheral Parish and Botcherby Ward remain unchanged.**

Stanwix Rural Parish

- 48 Development on the urban fringe of Carlisle extends into Stanwix Rural parish and the question arises of whether the areas concerned should remain parished. A specific request was also received to alter the boundary between Stanwix Rural and Rockcliffe parishes in the Harker Park area and a small anomaly in the boundary between Kingmoor and Stanwix Rural parish should be addressed.
- 49 Four Draft Recommendations were made in respect of Stanwix Rural parish, as follows:

Draft Recommendations

- 1 Vallum ward of Stanwix Rural parish be unparished and the number of Stanwix Rural parish councillors be reduced from 15 to 12. (Map 8)**
- 2 Windsor Park be excluded from Stanwix Rural parish and that the parish boundary (and relevant ward and electoral division boundaries) be altered accordingly. (Map 9)**
- 3 The boundary between Rockcliffe and Stanwix Rural parishes (and corresponding ward and electoral division boundaries) be amended to transfer the whole of Harker Park to Stanwix Rural parish. (Map 11)**
- 4 The detached part of Kingmoor parish be transferred to Stanwix Rural parish. (Map 12)**

- 50 If implemented, these recommendations would have a significant impact on Stanwix Rural parish and detailed representations have been submitted by the Parish Council in response to the Draft Recommendations (see Appendix 3). The proposals which affect the parish are discussed in turn below.

Vallum Ward

- 51 Following the Local Government Commission's review of the City's electoral arrangements, implemented in 1999, Stanwix Urban ward was enlarged to incorporate the whole of the newly created Vallum ward of Stanwix Rural parish (Map 8).
- 52 Lansdowne Close and part of Lansdowne Crescent form the western portion of Vallum Ward. A petition signed by 102 electors in the area (representing over 85% of households) was submitted in July 2000, seeking transfer out of the parish on the grounds that the boundary was out-dated and the residents did not feel part of the Houghton community. These streets are an extension of the urban area and are separated from Houghton by open farm land. Stanwix Rural parish council confirmed at that time that it had no objection to the Lansdowne portion being transferred out of its area.
- 53 The other residential part of Vallum ward comprises Millcroft, Whiteclosegate and two properties in Longlands Road (203 electors in total) and it was therefore appropriate to consider whether it too should continue to be in Stanwix Rural parish. The parish council, however, wished to retain this long established part of the parish which is much closer to Houghton than the Lansdowne area. The parish council considered that the natural boundary of the parish was at the division line where Brampton Road ends and Whiteclosegate houses commence, southwesterly to the River Eden including Rickerby and northwesterly to Tarraby, Shortdale and Blaylock Riggs Common.
- 54 The electors concerned were asked for their views and of the 60% who replied, 65% were in favour of remaining in the parish while 35% preferred the area to be unparished.
- 55 In the light of the transfer of the Vallum ward of the parish from the City ward of Stanwix Rural to Stanwix Urban in 1999 and the recent recommendation of the Parliamentary Boundary Commission that the whole of Stanwix Urban be contained within the Carlisle constituency, it becomes more difficult to sustain an argument in favour of the Whiteclosegate/Millcroft area remaining in Stanwix Urban parish and the Draft Recommendation was agreed accordingly. If the area transferred from the parish, there would be a consequent reduction in the number of parish councillors from 15 to 12 because currently 3 of the 15 represent Vallum ward.
- 56 In its response to the Draft Recommendations, the Parish Council reiterates its acceptance of the transfer of the Lansdowne part of Vallum Ward out of the parish but strongly opposes the proposed loss of the Whiteclosegate/Millcroft/Longlands Road area. The Parish Council points to the majority view of local residents in favour of remaining in the parish and emphasises the historical significance of the boundary.

- 57 The Parish Council argues that because the Local Government Commission created Vallum Ward in consequence of the review of the City's electoral arrangements, it was endorsing the legitimacy of the established boundary. The Commission had no statutory power to change parish boundaries, as opposed to their electoral arrangements, and the creation of Vallum Ward was a necessary step to provide for the transfer of its area to Stanwix Urban ward, in recognition of its affinity with urban Carlisle. The review recommendations of the Commission in respect of both the City and County Councils, cited by the Parish Council, do not mention realigning the parish boundary simply because it is not within the Commission's remit to do so. The lack of action by the Commission cannot therefore be taken as acceptance, or otherwise, of the existing parish boundary.
- 58 The Parish Council argues in favour of retaining the boundary in the Whiteclosegate area for historic reasons yet is content to amend it to exclude the Lansdowne area from the parish and even counter-proposes an alteration to the boundary to follow Longlands Road.
- 59 A small majority of residents favour remaining in the parish but it is nevertheless submitted that the interests of convenient local government would be best served if the parish, ward and City electoral divisions in this locality were all coterminous. **It is therefore recommended that the Draft Recommendation in respect of Vallum Ward of the parish be confirmed as the Council's Final Recommendation.**

Windsor Park

- 60 New housing development of about 150 properties is also taking place north of the Lansdowne area as an extension of Windsor Way. It is within Stanwix Rural parish but when completed will be partly in Vallum ward and partly in Houghton ward of the parish (see Map 8). The parish council was initially of the opinion that the development should transfer out of the parish. In order to rationalise the various boundaries in the locality, particularly if Vallum ward were to cease to exist, it would be necessary to alter both the parish boundary and the boundaries between Belah, Stanwix Rural and Stanwix Urban wards of the City and between Belah, Stanwix Urban and Stanwix & Irthington electoral divisions of the County.
- 61 56% of the 36 residents replied to consultation; 65% of them were in favour of the status quo and 35% supported the view of the parish council. The estate is, however, in a similar situation to the Lansdowne part of Stanwix Rural parish in that it is a continuation of existing residential development and has no affinity with the rest of the parish.

- 62 Having originally been content to see the Windsor Way extension becoming unparished, the Parish Council now supports the majority view of respondents to the consultation exercise in favour of remaining parished. While recognising the wishes of local residents (65% of the 56% of electors who replied supported the status quo), it is suggested that in this case greater weight should be given to the advantages of rationalisation of the various boundaries crossing the estate. If the parish, ward and electoral division boundaries are not realigned, confusion will only increase as the estate develops further.
- 63 **It is recommended that the Draft Recommendation be confirmed as the Council's Final Recommendation. (see Map 9)**

Stanwix Rural/Rockcliffe/Kingmoor

- 64 Harker Park is divided between Stanwix Rural and Rockcliffe parishes and Stanwix Rural parish council had a long standing wish to alter its western boundary so that the whole of Harker Park could be included in its area (see Map 10). The current boundary has been in existence since long before Harker Park was developed and the parish council felt that as it no longer follows any meaningful line which can be identified on the ground, the A7 trunk road would now form a more relevant boundary. About 60 electors would be affected by the proposal.
- 65 Realignment of parish boundaries in this area would also require amendment to City ward and County electoral division boundaries.
- 66 When the possibility of the present review was first raised with parish councils, Rockcliffe parish council expressed reservations about the proposed boundary change. The Council was concerned that if the 34 properties affected transferred to Stanwix Rural parish the resulting shortfall in revenue would necessitate an increase in the precept. In January 2000, the parish council reiterated its support for this view and also suggested that residents in the Stanwix Rural portion of Harker Park be consulted on whether they would wish to transfer to Rockcliffe parish on the grounds that they feel part of the Rockcliffe community and use its facilities.
- 67 All residents in the Harker Park area were asked for their views and of the 84% of those in Rockcliffe parish who replied, all wished to stay in that parish. 86% of those consulted in Stanwix Rural responded and 87% of them favoured a realignment of the parish boundary so that the whole of Harker Park could be included in Rockcliffe parish.

- 68 In its response to the Draft Recommendations, Stanwix Rural Parish Council accepts the transfer of those Harker Park properties in its area to Rockcliffe Parish but questions the need to include field numbers 8488 and 8571 within the realigned boundary of Rockcliffe parish. It is accepted that the boundaries of the properties in Harker Park would constitute a satisfactory parish and ward boundary and **it is therefore recommended that the Draft Recommendations be confirmed as the Council's Final Recommendations, subject to amendment to the proposed boundary, as shown on Map 11.**

Detached part of Kingmoor Parish

- 69 A narrow strip of uninhabited land to the east of California Lane, which lies between Stanwix Rural parish and Belah Ward, is part of Kingmoor parish although it is physically detached from the rest of the parish. The Draft Recommendation sought to correct this anomaly by transferring the land in question to Stanwix Rural parish.
- 70 As Stanwix Rural Parish Council rightly points out in its submission, a map illustrating this proposal was omitted from the published Draft Recommendations. The area of land in question is shown on Map 12 and **it is recommended that the Draft Recommendation be confirmed as the Council's Final Recommendation.**
- 71 The Parish Council representations draw attention to the effect on the parish precept of the proposed transfer of some 260 properties out of the parish (see Table 2 in the Parish Council's submission). Although an increase of approximately 20% in the precept would be required to maintain parish expenditure at the same level, this represents an actual increase of around £2.50 per annum for a Band A property and £7.50 for Band H. It is submitted that the financial implications should not be given undue weight when determining the Final Recommendations for effective local government in the parish.

Other Representations

- 72 Specific representations, discussed below, were received from parish councils concerning the boundaries between –

- (a) Hayton and Wetheral parishes
- (b) Stanwix Rural, Rockcliffe and Kingmoor parishes
- (c) Kirklington and Scaleby parishes

- 73 Hayton parish council also requested an alteration to the warding arrangements in the parish.

- 74 In addition to any parish councils mentioned elsewhere in this report, the following parish councils are content with the present arrangements:

Brampton	Irthington
Dalston	Kirkandrews
Denton Nether	

and no comments have been received from the following parish councils:

Arthuret	Nicholforest
Beaumont	Walton
Burgh-by-Sands	Westlington
Hethersgill	

Hayton/Wetheral

Draft Recommendation

No change be made to the boundary between Hayton and Wetheral parishes.

- 75 The boundary between Hayton and Wetheral parishes runs through Heads Nook and Warwick Bridge (see Map 13) and in its initial representations Hayton parish council took the view that it is anomalous for these villages to be split between two parishes. The parish council suggested that the Cairn Beck might be a more appropriate boundary in Heads Nook whilst in Warwick Bridge the River Eden should form the boundary. This would bring both villages within Hayton parish and increase the electorate of that parish from 1783 to about 2300. The parish council acknowledges, however, that any such boundary change would need a clear mandate from the residents of these villages and that no representations have been made by local people as evidence of any desire for change.
- 76 Wetheral parish council confirmed that no approaches have been made to either parish council asking for the matter to be discussed and they favour the status quo.

- 77 A realignment of the boundary between Hayton and Wetheral parishes would require a consequential change to the boundaries between Hayton and Great Corby & Geltsdale wards of the City and between Wetheral and Stanwix & Irthington electoral divisions of the County.
- 78 Hayton Parish Council does not wish to make any further representations in response to the Draft Recommendations and **it is recommended that the Draft Recommendation be confirmed as the Council's Final Recommendation.**

Hayton

Draft Recommendation

The electoral arrangements for Hayton parish be revised in accordance with the scheme favoured by the Parish Council.

- 79 Hayton Parish Council made a request prior to formal commencement of the review (and recommended in Report No. TC 200/99) that the electoral arrangements in the parish be changed. The parish was divided into four wards in 1950 and the parish council considered that the number of Councillors for each ward was no longer representative of the number of electors in those wards. Corby Hill ward in particular is now very much under-represented due to the increase in population in that part of the parish since the wards were first established.
- 80 In order to redress this imbalance to reflect the current distribution of electors and to take account of an overall increase in the parish electorate, the parish council favoured amendment to the warding scheme as follows:

<u>Ward</u>	<u>2000 Electorate</u>	<u>Existing No. of Councillors</u>	<u>Proposed No. of Councillors</u>
Corby Hill	820	3	5
Hayton	544	5	4
Heads Nook	294	2	2
Talkin	<u>125</u>	<u>1</u>	<u>1</u>
	1783	11	12

- 81 No proposals were submitted to alter the boundaries of the parish wards. The Draft Recommendation endorsed the proposed scheme in the interests of fairer and more effective local government in Hayton Parish and **it is recommended that the Draft Recommendation be confirmed as the Council's Final Recommendation.**

Kirklington/Scaleby

Draft Recommendation

No change be made in the boundary between Kirklington and Scaleby parishes.

- 82 Kirklington parish council, while being generally satisfied with the current arrangements, had suggested that residents of properties in the vicinity of Humphries House Lonning, which is close to Scaleby Hill in Scaleby parish, might feel more affinity with that parish than with Kirklington (see Map 14). Scaleby parish council agreed that the residents concerned may have closer community ties to Scaleby.
- 83 Although a relatively minor parish boundary change could transfer these properties from Kirklington to Scaleby, it would also require realignment of the City ward boundaries between Stanwix Rural and Lyne wards and between Stanwix & Irthington and Longtown & Bewcastle electoral divisions of the County.
- 84 The 9 residents affected were asked for their views; 7 replied and 5 favoured the status quo and the Draft Recommendation was framed accordingly. Scaleby Parish Council responded to the Draft Recommendations to say that it had no further comments to make.
- 85 **It is recommended that the Draft Recommendation be confirmed as the Council's Final Recommendation.**

IMPLEMENTATION

- 86 The final stage of the review requires the Council to publish its final recommendations and submit any proposals to the Secretary of State which require his consent. Changes which do not need the agreement of the Secretary of State will be implemented by local Order. The timing of the implementation of the various proposals will therefore depend on whether they need the Secretary of State's approval. The summary of recommendations on page 2 shows which proposals have to be referred to the Secretary of State and which can be acted upon locally.
- 87 Changes would normally be implemented at the next scheduled parish elections following their approval. Elections to parish councils are held in the same year as elections of City Councillors for the ward in which the parish lies (see Appendix 4 - Cycle of Parish Elections). Any proposals requiring the Secretary of State's consent and affecting parishes with elections in 2003 would hopefully be approved in time for implementation at those elections.

- 88 Three final recommendations would, if approved, fall to be implemented by the Council, namely:
- (a) alteration of the electoral arrangements in Hayton parish;
 - (b) reduction in the number of Councillors for Midgeholme parish; and
 - (c) grouping of Carlatton and Cumrew parishes and creation of a common parish council for the group.
- 89 **It is recommended that the alteration of electoral arrangements in Hayton and Midgeholme parishes be made at the next scheduled elections in those parishes, i.e. 2004 and 2003 respectively and Orders be made under Section 17 of the Local Government and Rating Act 1997 to give effect thereto.**
- 90 Carlatton and Cumrew are in Great Corby and Geltsdale Ward and the election of Councillors for the new Parish Council serving these parishes should therefore coincide with the election of the City Councillor for that Ward. As the next scheduled election in the Great Corby and Geltsdale ward, however, will not take place until 2004, **it is recommended that the election of Councillors for the common Parish Council for Carlatton and Cumrew be held in May 2002; that the initial term of office of Parish Councillors be two years; that elections be held in 2004 and every fourth year thereafter; and an Order be made under Section 11 of the Local Government Act 1972 to give effect thereto.**

February 2002

APPENDIX 1

STATUTORY POWERS

- 1 Under Section 9 of the Local Government and Rating Act 1997, the Council may review the whole or part of its area and **make recommendations to the Secretary of State** for
 - (a) the alteration of the area of a parish (i.e. change parish boundaries);
 - (b) the creation of new parishes by the joining or splitting of existing parishes or parts of parishes or by the joining of unparished areas with existing parishes;
 - (c) the creation of new parishes in unparished areas;
 - (d) the abolition of parishes with or without the distribution of their area among other parishes.
- 2 Any recommendation to alter the area of a parish which has a parish council may also include recommendations for changes to the electoral arrangements for the parish council. 'Electoral arrangements' means
 - (a) the number of parish councillors;
 - (b) the question of whether or not the parish should be divided into wards for the purposes of the election of councillors;
 - (c) the number and boundaries of any such wards;
 - (d) the number of councillors to be elected for any such ward; and
 - (e) the name of any such ward.
- 3 Section 17 of the 1997 Act also allows the Council to review the electoral arrangements of existing parishes and make changes **without reference to the Secretary of State**, except in cases where arrangements were put in place by order of the Secretary of State within the previous five years. In these circumstances, his consent is required. Any proposals under the current review to alter the boundaries of the wards of Stanwix Rural parish, for example, would need the Secretary of State's approval because they were changed in 1998 as a consequence of the review of the City's electoral arrangements.
- 4 The Council also has power under Section 11 of the Local Government Act 1972 to group parishes, again **without reference to the Secretary of State**. This means that parishes which no longer require a separate parish council, or parishes with less than 200 electors each and no parish council, can be grouped so that a parish council can be formed. This may avoid the need for substantive changes to parish boundaries, the creation of new parishes, or the abolition of very small parishes where, despite their size, they still reflect community identity. Grouping requires the consent of the parish meeting of each of the parishes concerned.

- 5 In assessing the need for new or changed parish arrangements, the Council must observe the requirement of the 1997 Act (Section 22) to have

“regard to the need

(c) to reflect the identities and interests of local communities, and

(d) to secure effective and convenient local government.”

- 6 The Council must also take account of any guidance given by the Secretary of State. DETR Circular 11/97 contains advice on conducting reviews and details the procedural requirements. It is the Department’s view that, for the purposes of community representation and local administration, it is desirable that a parish should reflect a small, distinctive community of interest with its own sense of identity. The feeling of local community and the wishes of local inhabitants are the primary considerations.
- 7 The identification of a community is not a precise or rigid matter. The pattern of daily life in each of the exiting communities, the local centres for education, shopping, community activities, worship, leisure pursuits, transport and means of communication generally will all have an influence. The focus of community feeling will differ from place to place and between different types of settlement. A scatter of hamlets, for example, may have a feeling of community within each hamlet, meriting a separate parish for each one, or amongst a number of hamlets, for which one parish covering them all may be appropriate.
- 8 The boundaries between parishes need to reflect the “no-man’s-land” between communities represented by areas of low population or barriers such as rivers, roads or railways. They need to be, and likely to remain, easily identifiable. They must fall within one district council area and must not generally cross district ward boundaries or county electoral division boundaries.
- 9 The Department also advises that any changes should result in parishes, or groups of parishes, with sufficient population to justify the establishment of a parish council in each, rather than rely on parish government by parish meeting only. A parish with 200 or more electors must have a parish council and a parish with between 150 and 200 electors must have a council if the parish meeting resolves in favour of one. Where a parish with less than 150 electors resolves in favour of a parish council, it is at the district council’s discretion whether or not to establish one. A parish council must have at least five members.

APPENDIX 2

REVIEW PROCEDURE

Section 10 of the Local Government and Rating Act 1997

- 1 If a district council or unitary county council decide to conduct a review under section 9, they must as soon as reasonably practicable take the steps they consider sufficient to secure that persons who may be interested in the review are informed of-
 - (a) the decision to conduct the review,
 - (b) the subject-matter of the review, and
 - (c) the period within which representations about the subject-matter of the review may be made.
- 2 In conducting the review, the council must take into consideration any representations made to them within the period mentioned in subsection (1)(c).
- 3 After conducting the review, unless they decide not to make any recommendations to the Secretary of State, the council must –
 - (a) prepare draft recommendations and take steps they consider sufficient to secure that persons who may be interested in them are informed of them and of the period within which representations about them may be made,
 - (b) deposit copies of the draft recommendations at their principal office and keep the copies available for inspection at that office throughout the period within which representations about them may be made, and
 - (c) take into consideration any such representations made to them within that period.
- 4 If the council then decide to make any recommendations, they must send them to the Secretary of State and, as soon as they do so –
 - (a) deposit copies of the recommendations at their principal office, and
 - (b) take the steps they consider sufficient to secure that persons who may be interested in the recommendations are informed of them and of the period within which the copies may be inspected.
- 5 Further, the council must keep the copies available for inspection at their principal office throughout the period within which they may be inspected.

APPENDIX 3

REPRESENTATIONS IN RESPONSE TO DRAFT RECOMMENDATIONS

- 1 Representations from Stanwix Rural Parish Council
- 2 E-mail from Wetheral Parish Council
- 3 Letter from Hayton Parish Council
- 4 Letter from Chairman, Cumrew Parish
- 5 Letter from Scaleby Parish Council
- 6 Letter from Cumbria County Council

**REPRESENTATIONS FROM
STANWIX RURAL PARISH COUNCIL
IN RESPECT OF

CARLISLE CITY COUNCIL REVIEW OF PARISH
BOUNDARIES AND
ELECTORAL ARRANGEMENTS-DRAFT
RECOMMENDATIONS, SEPTEMBER 2001**

1. INTRODUCTION

1.1 This document contains the responses of Stanwix Rural Parish Council to proposals relating to the Parish of Stanwix Rural, as contained within Carlisle City Council Review of Parish Boundaries and Electoral Arrangements Draft Recommendations - September 2001.(The Draft).

1.2 Table 1, of The Draft, shows Stanwix Rural Parish to have 2,365 electors and 15 Parish Councillors, each representing 157 electors; making Stanwix Rural Parish the third largest under review.

1.3 Page 7 of The Draft lists 37 parishes which are subject to review. Of these 26 are to remain unchanged. The remainder indicate 12 proposed changes, 6 of which involve Stanwix Rural Parish, 4 of these require the approval of the Secretary of State. Half of all proposed changes are, therefore, of fundamental concern to Stanwix Rural Parish Council.

1.4 The Draft makes frequent reference to the D.E.T.R. Circular 11/97. Therefore, in its' response, to recommendations contained within The Draft, Circular 11/97 is also quoted by Stanwix Rural Parish Council. The Parish Council also refer to Local Government Commission Reviews of 1997 and 1999; relating to Carlisle City Council and Cumbria County Council.

2. DRAFT RECOMMENDATIONS REGARDING STANWIX RURAL PARISH.

2.1 Under the heading "Summary of Draft Recommendations", the City Council propose the following, (numbered as in The Draft):-

2.2 Vallum Ward of Stanwix Rural Parish become unparished and the number of Stanwix Rural Parish Councillors be reduced from 15 to 12(page 21);

2.3 Windsor Park be excluded from Stanwix Rural Parish and parish, ward and electoral division boundaries in the area be altered accordingly (page 23);

2.4 The boundaries between Rockcliffe and Stanwix Rural Parishes (and corresponding ward and electoral division boundaries) be altered to transfer the whole of Harker Park to Rockcliffe Parish (page 35);

2.5 The detached part of Kingmoor Parish be transferred to Stanwix Rural Parish (page 35);

2.6 These recommendations are fully detailed in paragraphs 36-44 of The Draft, under the heading "Urban Fringe" and in paragraphs 67-73 under the heading Stanwix Rural/Rockcliffe/Kingmoor."

3. PRECEPT

3.1 Carlisle City Council Draft Review recommends the removal, from Stanwix Rural Parish, of 263 properties; or, approximately 20% (19.98%) of the 2002/03 total of 1,316 properties, upon which precept is charged.(appendix 1 Table 1) It is obvious, therefore,that a 20% increase in precept must then be levied, overall, upon the remaining properties,in order that the parish may recover the shortfall.Failure to maintain the current precept certainly resulting in an unacceptable reduction in the level and quality of services.

3.2 Stanwix Rural Parish Council objects most vehemently to enforced consideration of such quantum increase in the parish precept,when it has always been at pains to keep such increases, as are necessary, to an absolute minimum.(appendix 1 Table 2)

4. RESPONSES OF STANWIX RURAL PARISH COUNCIL TO DRAFT RECOMMENDATIONS.

4.1 In the interests of clarity the Parish Council responses, to the above Draft Recommendations, are given, in respect of area and in order of simplicity.

4.2 THE DETACHED PART OF KINGMOOR,(DRAFT PARA 73).

This area is not clearly marked on any map within The Draft, in fact it is not shown in any way, whatsoever. This omission is entirely contrary to paragraph 29 of Circular 11/97.

4.3 In the absence of accurate mapping, it is impossible for Stanwix Rural Parish Council to make any considered comment in respect of this area.

4.4 LANSDOWNE AREA;COMPRISING LANSDOWNE CRESCENT, LANSDOWNE CLOSE AND LANSDOWNE COURT,(DRAFT PARAS 36-37).

It is quite obvious that the residents of this area feel a general affinity with the urban area of the city ,85% of households having petitioned to become unparished. Therefore;

4.5 In the interests of local democracy and in accordance with guidance given in Circular 11/97 that;

"The feeling of local community and the wishes of local inhabitants are the primary considerations." Stanwix Rural Parish Council must relinquish all of any authority it may have in respect of that portion of the parish referred to as "The Lansdowne Area"

4.6 HARKER PARK, (DRAFT PARAS, 67-72)

Stanwix Rural Parish Council has long wished to include within the parish, that portion of Harker Park presently lying within the boundary of Rockcliffe Parish; representations have been repeatedly made in this regard. However, of those households presently contained within Stanwix Rural Parish, 87% of those responding to consultation wish to become associated with Rockcliffe Parish. Harker Park respondents presently resident within Rockcliffe Parish wished to remain so.

4.7 In the interest of local democracy and in accordance with guidance given in Circular 11/97 that;

"the feeling of local community and the wishes of local inhabitants are the primary considerations.";

Stanwix Rural Parish Council should, therefore, relinquish all of any authority it may have, in respect of those households comprising the Harker Park portion of the Parish of Stanwix Rural.

4.8 The Parish Council do, however, question the need to include fields to the north and south of Harker Park, numbered 8488 and 8571, within the realigned boundary of Rockcliffe Parish. Clearly defined property boundaries exist which, surely, meet statutory requirements in respect of identifying parish limits.

4.9 WINDSOR PARK, (DRAFT PARAS 42-44).

As this is a new development, geographically and demographically, similar to the Lansdowne area; the Parish Council has, in the past, commented that it would be content to relinquish the area. However, in view of the response to consultation, i.e. 65% per cent of respondents wish to remain parished, this opinion must now be reconsidered.

4.10 In the interests of local democracy and in accordance with the guidance given in Circular 11/97 that:

"the feeling of local community and the wishes of local inhabitants are the primary considerations";

the Parish Council must now regard the Windsor Park area as an integral part of the parish, which should be retained as such; along with any future extension of Windsor Park, which may occur within the existing parish boundaries.

4.11 WHITECLOSEGATE / MILLCROFT / LONGLANDS ROAD, (DRAFT PARAS 38-41)

Stanwix Rural Parish Council has always held that this area should, as part of the local community, remain within the parish. The Parish Council considers the natural boundary of the Parish to be the division line where Brampton Road ends and Whiteclosegate commences, following the line of Longlands Road North and encompassing Rickerby, before intersecting the River Eden. indeed, this boundary seems to adhere closely to that defined, as part of the northern boundary of the the original Parish of Stanwix, by the Reform Act (1832) and which later, for many years, marked the northern boundary of the City of Carlisle. Paragraph 38 of the Draft Review, itself, states that the parish council wish to retain this;

"...long established part of the parish which is much closer to Houghton than the Lansdown area."

4.12 The historical significance of the existing parish boundary and its importance to the local community was recognised when Vallum Ward was created, following the Local Government Commission Final Recommendations On Future Electoral Arrangements For Carlisle In Cumbria (November 1997); which proposed that (para 42) :

" Stanwix Rural Parish be warded to create an additional parish ward called, Vallum, with some 450 electors and that the parish ward should be included in Stanwix Urban Ward for district electoral purposes, as put forward by the City Council."

This recommendation also clearly reflects the emphasis of Circular 11/97 that, when making boundary and electoral changes :

"The feeling of local community and the wishes of local inhabitants are the primary consideration" (11/97 para 7).

4.13 The appropriateness of the existing boundaries was reinforced in the Local Government Final Recommendation On Future Electoral Arrangements For Cumbria County Council (November 1999) which stated , with regard to Stanwix and Irthington division (and others):

"we are satisfied that the County Councils proposals for this area would provide good electoral equality under the revised forecasts, would achieve a high level of coterminosity and would command a substantial degree of local support." (para 110)

4.14 The Local Government Commission explained in its' paragraph 110 that the proposals referred to above were the County Councils stage 1 proposals, more fully described in a previous paragraph, 102, thus:

"Finally it is proposed a new Stanwix and Irthington division comprising the remainder of the Parish of Hayton (the parish wards of Corby, Hayton, and Talkin) with Stanwix Rural ward and the parishes of Hethersgill and Stapleton." (para 102)

4.15 None of these Recommendations make any mention whatsoever of realigning the boundary of Stanwix Rural Parish, or the abolition of Vallum ward. Indeed the existing southern boundary of the Parish (within the urban division) is clearly defined upon the map of the Commissions Final Recommendations (1999) where it may, clearly, be seen to bisect the Stanwix Urban ward of the City of Carlisle.

4.16 In response to consultation 65% of respondents, inhabiting the Whiteclosegate/ Millcroft/ Longlands Road community, were in favour of remaining in Stanwix Rural Parish.

4.17 In the interests of local democracy and in accordance with guidance given in Circular 11/97 that:

"the feeling of local community and the wishes of local inhabitants are the primary considerations."

and to accord with the recommendations of the 1997 and 1999 Local Government Commission Reviews; Stanwix Rural Parish Council must uphold their opinion that; the community of Whiteclosegate/ Millcroft/ Longlands Road should remain within the boundaries of Stanwix Rural Parish.

4.18 PROPOSAL TO UNPARISH VALLUM WARD AND REDUCE THE NUMBER OF STANWIX RURAL PARISH COUNCILORS FROM 15 TO 12, (DRAFT PARA 41)

The foregoing paragraphs show, quite clearly, that this proposal is contrary to the wishes of the majority of the inhabitants of Vallum Ward and those of

Stanwix Rural Parish Council. Further, the proposal contradicts the final recommendations of the Local Government Commission, 1997 and that of 1999, both referred to above. Therefore;

4.19 In the interests of local democracy and in accordance with guidance given in Circular 11/97 that;

"The feelings of local community and the wishes of inhabitants are the primary considerations."

And to accord with the recommendations of the 1997 and 1999 Local Government Commission Reviews; Stanwix Rural Parish Council must recommend that Carlisle City Council withdraw all proposals, pursuant to the abolition of Vallum Ward of Stanwix Rural Parish (excepting those which may apply uniquely to that portion of Vallum Ward which is defined as "The Lansdowne Area".)

5. PROPOSED RE-ALIGNMENT OF BOUNDARY OF VALLUM WARD BY STANWIX RURAL PARISH COUNCIL.

5.1 Stanwix Rural Parish Council wish to propose re-alignment of the southern boundary of Vallum Ward to exclude that area of the parish defined as "The Lansdowne Area" and to include the northern side of Longlands Road North; as delineated on map 1. Further that this revised boundary should also define other ward and electoral division boundaries.

6. CONCLUSIONS.

6.1 In its recommendations relating to the Harker Park and Lansdowne areas, of Stanwix Rural Parish, Carlisle City Council may be seen to accord with the primary considerations emphasised in Circular 11/97; in that it responds positively to the feeling of local community and the wishes of local inhabitants. However, in its recommendations relating to Windsor Park, Whiteclosegate/ Millcroft/ Longlands Road and its proposal to un-parish Vallum Ward, Carlisle City Council rejects entirely:

- a. The feeling of local Community and the wishes of local inhabitants.
- b. The primary considerations given in Circular 11/97 in respect of local community and inhabitants.
- c. The historic and local significance of the parish boundary.
- d. Its own 1997 proposals.
- e. The final recommendations of the Local Government Commission, 1997.

- f. The final recommendations of Local Government Commission, 1999.
- g. The repeatedly stated opinion of Stanwix Rural Parish Council.

6.2 Carlisle City Council seeks to justify its rejection of points a-g above by stating that these would be in the interests of "effective local government"; a consideration which, according to Circular 11/97, is subordinate to the feeling of local community and the wishes of local inhabitants.

Both considerations could be fulfilled, however, by the simple expedient of altering the relevant ward and electoral division boundaries, (as proposed by the City Council in the cases of Harker Park and Windsor Park), so as to remove the problematic areas of Stanwix Rural Parish from the urban division and thus restore the entire parish to the rural area; to the great delight of the majority of local inhabitants.

APPENDIX 1- TABLES
APPENDIX 2-MAP 1

TABLE 1 - POTENTIAL REDUCTION IN NUMBER OF PROPERTIES PER BAND.

BAND	A	B	C	D	E	F	G	H	UNBANDED	TOTAL
EXISTING 2001/02	71	185	398	333	174	91	21	2		1,275
EXISTING 2002/03	64	190	415	342	184	98	21	2		1,316
RECOMMENDED TO BE REMOVED FROM PARISH	2	25	44	134	45	11	1		1	263
TO REMAIN IN PARISH	62	165	371	208	139	87	20			1,053

TABLE 2 - POTENTIAL EFFECT OF REVIEW UPON PRECEPT (£)

BAND	A	B	C	D	E	F	G	H	UNBANDED	TOTAL
PRECEPT 2001/02 =21,000	12.24	14.28	16.31	18.35	22.43	26.51	30.59	36.71		23,143.81
PRECEPT 2002/03 =22,000	12.33	14.39	16.44	18.50	22.61	26.72	30.83	37.00		24,173.05
POTENTIAL DEFICIT PER BAND	24.66	379.75	723.36	2,479	1,017.45	293.92	30.83			4,948.97
POTENTIAL PRECEPT PER PROPERTY BY BAND	12.73	16.69	18.39	30.42	29.93	30.10	32.37			
REVISED PRECEPT 2002/03 22,550 = AVERAGE PRECEPT INCREASE PER PROPERTY OF										4.70

APPROXIMATE FIGURES CALCULATED TO NEAREST WHOLE PENNY. BASED UPON INFORMATION SUPPLIED BY CARLISLE CITY COUNCIL.

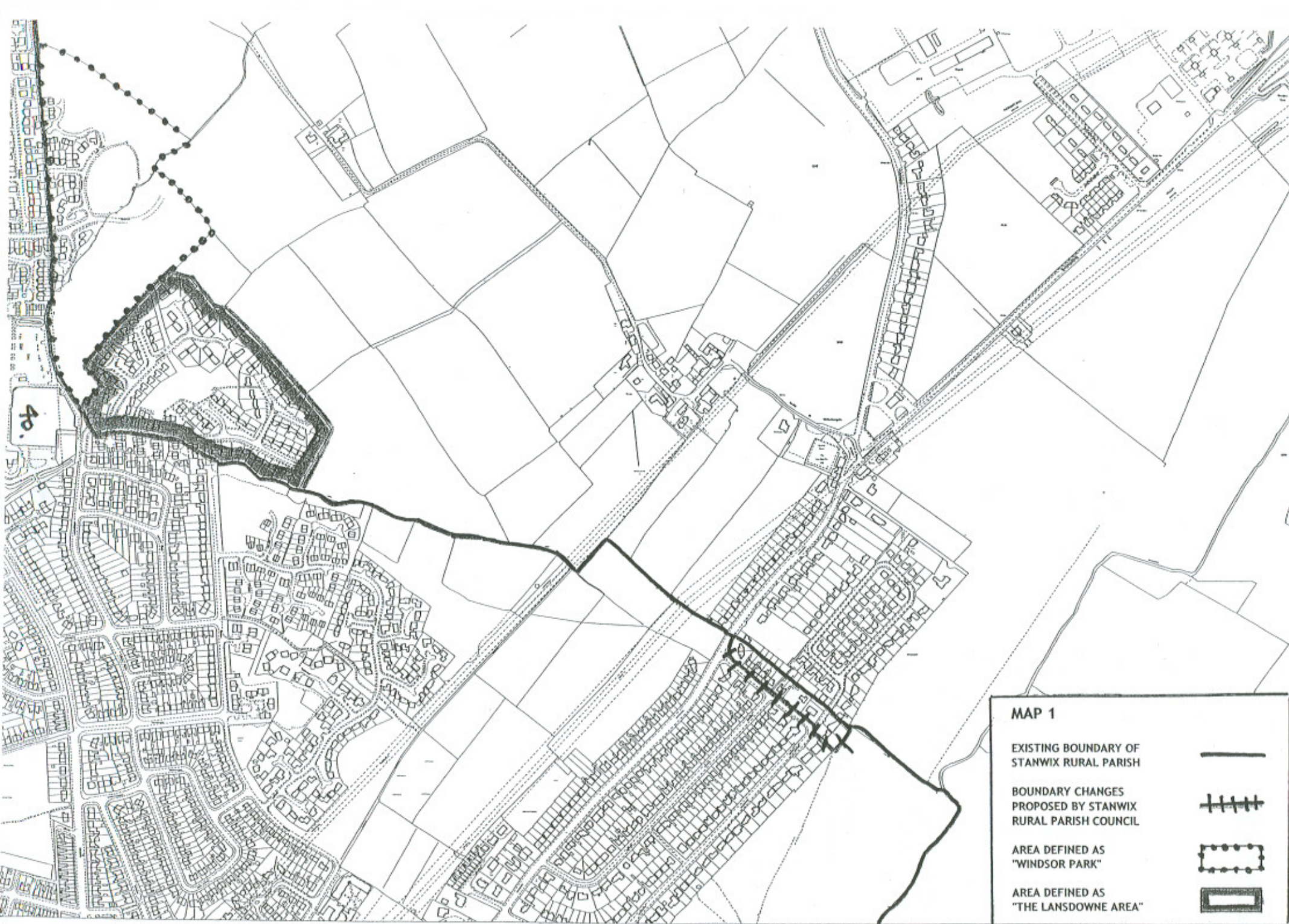

David Mitchell

From: Gillian Kartach [gilliank@carlisle-city.gov.uk]
Sent: 18 October 2001 12:56
To: 'davidm@carlisle-city.gov.uk'
Subject: Parish Boundary Review

Thank you for the paperwork received 9 October concerning the above.

This matter has been discussed by the members of the council and below are their comments:

Paragraph 50 - Carleton Grange Estate
The parish council agree to the recommendations.

Paragraph 55 - The Limes, Scotby Ward
The members thought that the residents in this development may not feel affiliation to the parish but had not consulted with the residents. When consultation was carried out a high response rate of 85% was returned and 97% of those responses wished to remain within the parish.

The arguments put forward by your department have merit. The council is keen to retain and defend the "green belt" between Scotby and the urban area which would keep The Limes development separated from Scotby village, but the council is apolitical and their policies, aims and objectives are always with a view to benefitting the parishioners. With this in mind the council therefore, must object to your recommendations which is contrary to the wishes of the parishioners and the people the council is elected to serve.

Should you have any queries please do not hesitate to contact me.

Gillian Kartach
Clerk

Our ref: 2290

Your ref: DAM/Parish Review

23 October 2001

For the attention of **Mr D Mitchell**
Town Clerk & Chief Executive Office
Carlisle City Council
Civic Centre
CARLISLE
CA3 8QG

Dear Mr Mitchell

Re: Review of Parish Boundaries and Electoral Arrangements for Hayton Parish

My thanks for your letter of 4 October 2001 and the copy of the Council's Draft Recommendations.

With regard to Hayton Parish, this document recommends no change to Parish Boundaries, but agrees the change of the number of Councillors to 12 in total with the ratio changing i.e. Hayton Ward down 1 to 4, whilst Corby Hill Ward increases by 2 to 5, representing more fairly the numbers of electorate.

The information as contained on page 31 paragraph 6 for boundaries recommendation + page 32, paragraph 64 for recommendations regarding Electoral Arrangements has been conveyed to the Council Members, who were of the opinion that previous representations had been fairly made. The Council does not, therefore, wish to make further representations at this stage. We look forward to receiving the final decision in due course.

Yours sincerely

J. P. Thomas

J P Thomas
Clerk to Hayton Parish Council

Peter Stybelski BSc MSc
Town Clerk and Chief Executive
Carlisle City Council
Civic Centre
CARLISLE
CA3 8QG

Rose Cottage,
Cumrew,
BRAMPTON
Cumbria
CA8 9DD

14th November 2001

FAO Mr. Mitchell

Dear Sir

Review of Parish Boundaries and Electoral Arrangements

I refer to your letter dated 4th October 2001 which enclosed a copy of the Council's Draft Recommendations for the above.

As we subsequently discussed a joint parish meeting with Carlattan was held on Tuesday 13th November at which the matter was considered. I am pleased to report that both parish meetings formally approved the formation of a common parish council with the number of Councillors being 2 for Carlattan and 4 for Cumrew.

Mr. Osborne of Carlattan parish asked that I inform you of the decision on his behalf and we await further information regarding the establishment of the new parish council.

Yours sincerely



P.L. Robinson
Chairman
Cumrew Parish Meeting

c.c. Patrick Osborne, Black Dub, Heads Nook, BRAMPTON, CA8 9BX

**scaleby
parish
council**

Clerk : Clive Moth
Sunnynook
Scalebyhill
CARLISLE CA6 4LY
Tel: 01228 675328
E-mail: CliveM@Carlisle-city.gov.uk

Town Clerk and Chief Executive
Carlisle City Council
Civic Centre
CARLISLE CA3 8QG

Attention Mr D Mitchell

22.11.01

Dear Mr Stybelski

Review of Parish Boundaries and Electoral Arrangements

Further to your letter of 4th October 2001 my Council have considered the City Council's draft recommendations and offer no comment.

Yours sincerely



Clive Moth
Clerk to the Council



COUNTY COUNCIL

Finance and Central Services

Member Services Unit

The Courts Carlisle
Cumbria CA3 8LZ
tel- 01228 606060
fax- 01228 606372
minicom- 01228 606336
email- member.services@cumbriacc.gov.uk

29 November 2001
Your ref: DAM/Y.16
Our ref: mk/lh ssu.10/ssu.13.03
Enq to: Martin Kennedy
Direct Line: (01228) 606358

CHIEF EXECUTIVE'S DEPT	
- 3 DEC 2001	
PASSED TO	DAM
ANSWERED	
MAIL LOG	✓

P Stybelski Esq
Town Clerk and Chief Executive
Carlisle City Council
Civic Centre
CARLISLE
CA3 8QG

Dear Mr Stybelski

CARLISLE CITY COUNCIL REVIEW OF PARISH BOUNDARIES AND ELECTORAL ARRANGEMENTS

I refer to your letter of 11 October enclosing the draft recommendations.

I have now reported the matter to the County Council Local Committee for Carlisle on 9 November and the Cabinet on Wednesday 28 November.

The contents of the report were noted. Those Members of the County Council who are directly affected by the proposals have been asked to make any representations direct to the City Council.

Yours faithfully

R F Mather

Director of Finance and Central Services
(County Returning Officer)

45.

APPENDIX 4

City of Carlisle

Cycle of Elections in Parished Wards – 1999 to 2004

C = City Council election

P = Parish Council election

Ward	No. of City Councillors	Parish	1999 ¹	2000	2001 ²	2002	2003	2004
Brampton	2	Brampton	C	C P		C		C P
Burgh	1	Beaumont Burgh-by-Sands Orton	C P P P				C P P P	
Dalston	3	Cummersdale Dalston St. Cuthbert Without	C P	C		C P P	C P	C
Great Corby & Geltsdale	1	Carlattan ³ Castle Carrock Cumrew ³ Cumwhitton Geltsdale ³ Hayton (Talkin) Wetheral (Great Corby)	C	C P P P P P				P P P P
Hayton	1	Hayton (Hayton) Hayton (Heads Nook) Hayton Corby Hill)	C	C P P P				C P P P
Irthing	1	Askerton ³ Burtholme Denton Nether Denton Upper Farlam Kingwater Midgeholme Walton Waterhead	C P P P P P P P P				C P P P P P P P	
Longtown and Rockcliffe	2	Arthuret Kirkandrews Rockcliffe Westlinton	C P P P P			C	C P P P P	
Lyne	1	Bewcastle Hethersgill Kirklington Middle Nicholforest Solport Stapleton	C P P P P P P				C P P P P P P	
Stanwix Rural	2	Irthington Kingmoor Scaleby Stanwix Rural (3 wards)	C P P P P			C	C P P P P	
Wetheral	2	Wetheral (all wards except Great Corby)	C	C P		C		C P

Notes

1. Elections were held in all City Wards in 1999.
2. County Council elections in 2001 – no City Council elections.
3. Parish with no parish council.



Parish boundary - - - -

City Ward boundary

Key to Wards

- | | | | |
|---|---------------------------|----|-------------------------|
| 1 | Brampton | 6 | Irthing |
| 2 | Burgh | 7 | Longtown and Rockcliffe |
| 3 | Dalston | 8 | Lyne |
| 4 | Great Corby and Geltsdale | 9 | Stanwix Rural |
| 5 | Hayton | 10 | Wetheral |

MAP 2

BEWCASTLE PARISH

ASKERTON PARISH

KINGWATER PARISH

STAPLETON PARISH

Parish boundary

Possible revised boundary

Reproduced from the Ordnance Survey mapping with the permission of Her Majesty's Stationery Office. Crown copyright. Unauthorised reproduction infringes Crown copyright and may lead to prosecution or civil proceedings. Carlisle City Council. Licence No. LA077429

Date: February 2002

MAP 3

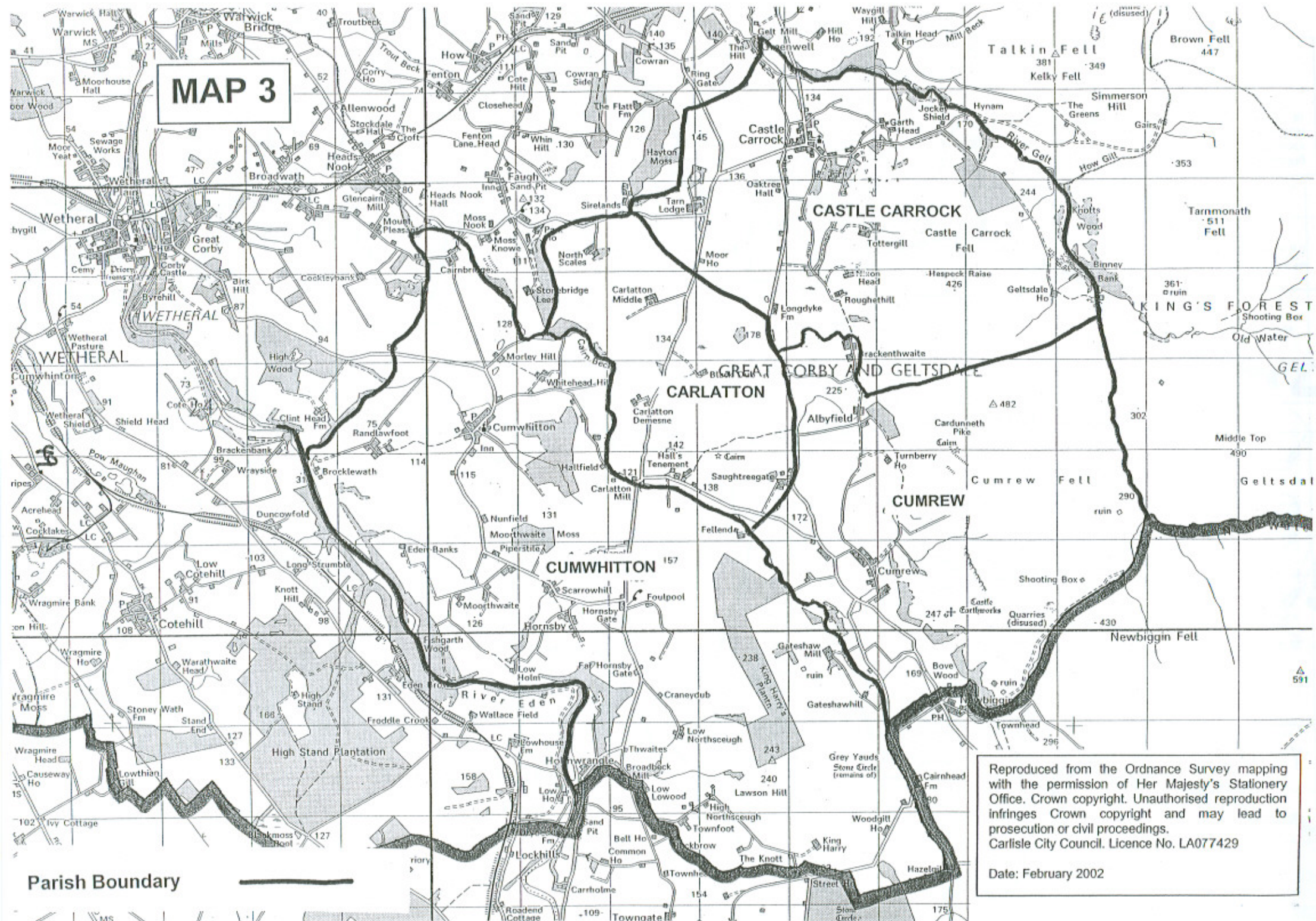

Parish Boundary

Reproduced from the Ordnance Survey mapping with the permission of Her Majesty's Stationery Office. Crown copyright. Unauthorised reproduction infringes Crown copyright and may lead to prosecution or civil proceedings. Carlisle City Council. Licence No. LA077429

Date: February 2002

MAP 4

CASTLE CARROCK PARISH

GELTSDALE PARISH

Parish Boundary

Reproduced from the Ordnance Survey mapping with the permission of Her Majesty's Stationery Office. Crown copyright. Unauthorised reproduction infringes Crown copyright and may lead to prosecution or civil proceedings. Carlisle City Council. Licence No. LA077429

Date: February 2002

MAP 5

HARRABY WARD

WETHERAL PARISH

Area proposed to transfer from
Harraby Ward to St. Cuthbert Without Parish

Area proposed to transfer from
Wetheral Parish to St. Cuthbert Without Parish

ST. CUTHBERT WITHOUT PARISH

Reproduced from the Ordnance Survey mapping with the permission of Her Majesty's Stationery Office. Crown copyright. Unauthorised reproduction infringes Crown copyright and may lead to prosecution or civil proceedings.
Carlisle City Council. Licence No. LA077429

Date: February 2002

Parish and Ward boundary

Proposed Parish and Ward boundary

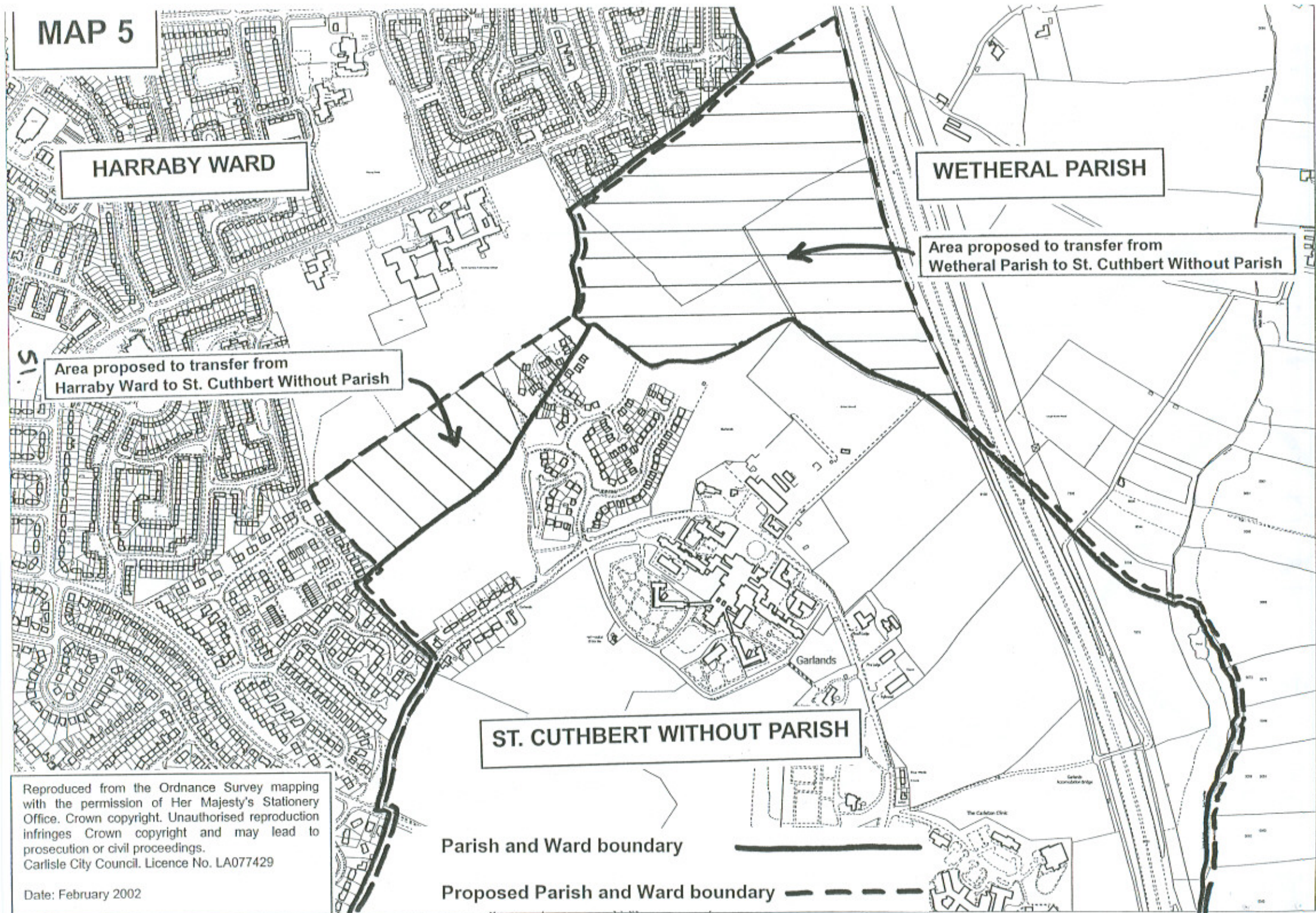

MAP 6

HARRABY WARD

WETHERAL PARISH

ST. CUTHBERT WITHOUT
PARISH

Carleton Grange Estate



Parish and Ward boundary

Proposed Parish and Ward boundary

Reproduced from the Ordnance Survey mapping with the permission of Her Majesty's Stationery Office. Crown copyright. Unauthorised reproduction infringes Crown copyright and may lead to prosecution or civil proceedings.
Carlisle City Council. Licence No. LA077429

Date: February 2002

MAP 7

WETHERAL PARISH

BOTCHERBY WARD

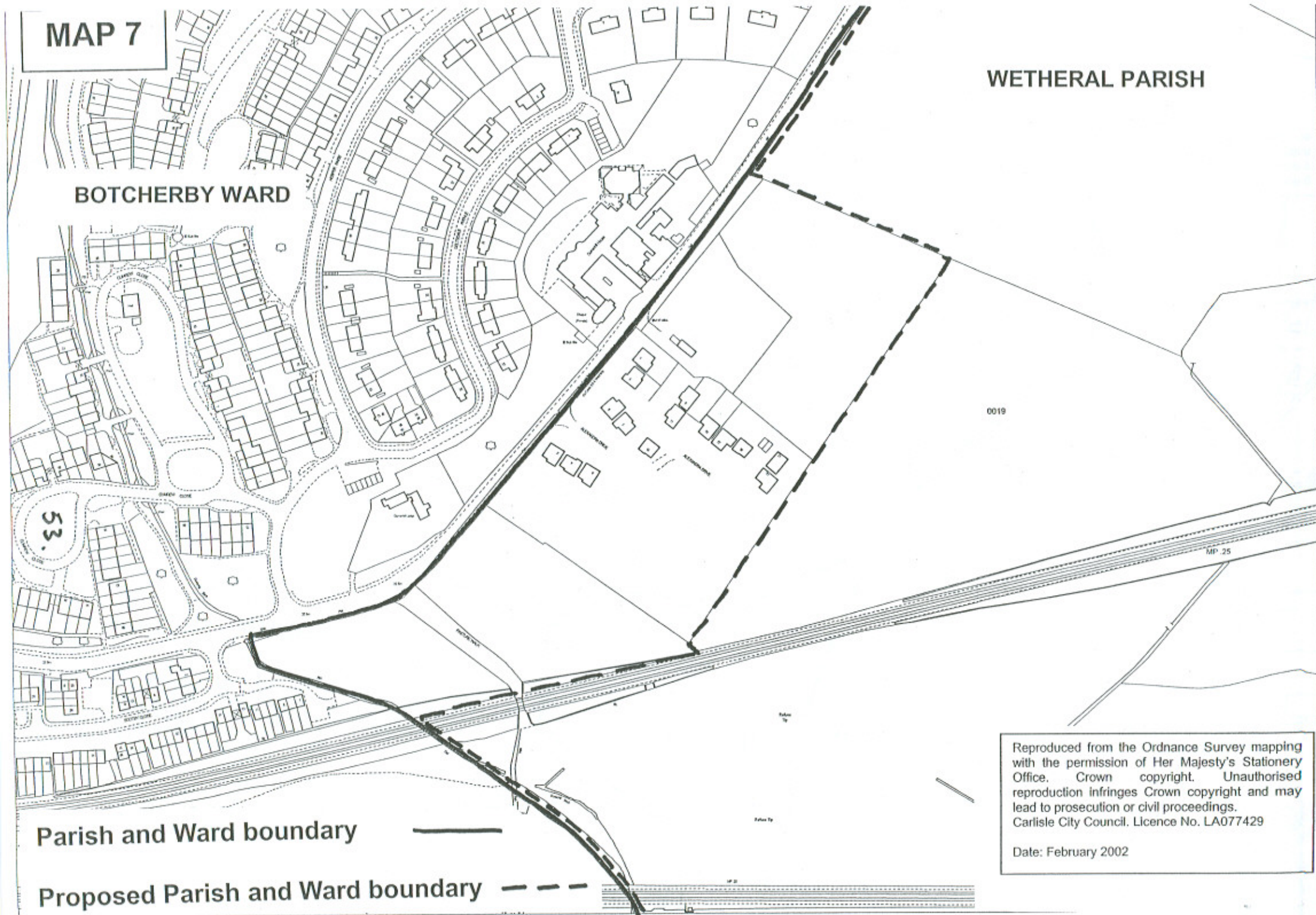

Parish and Ward boundary

Proposed Parish and Ward boundary

Reproduced from the Ordnance Survey mapping with the permission of Her Majesty's Stationery Office. Crown copyright. Unauthorised reproduction infringes Crown copyright and may lead to prosecution or civil proceedings. Carlsle City Council. Licence No. LA077429

Date: February 2002

MAP 8

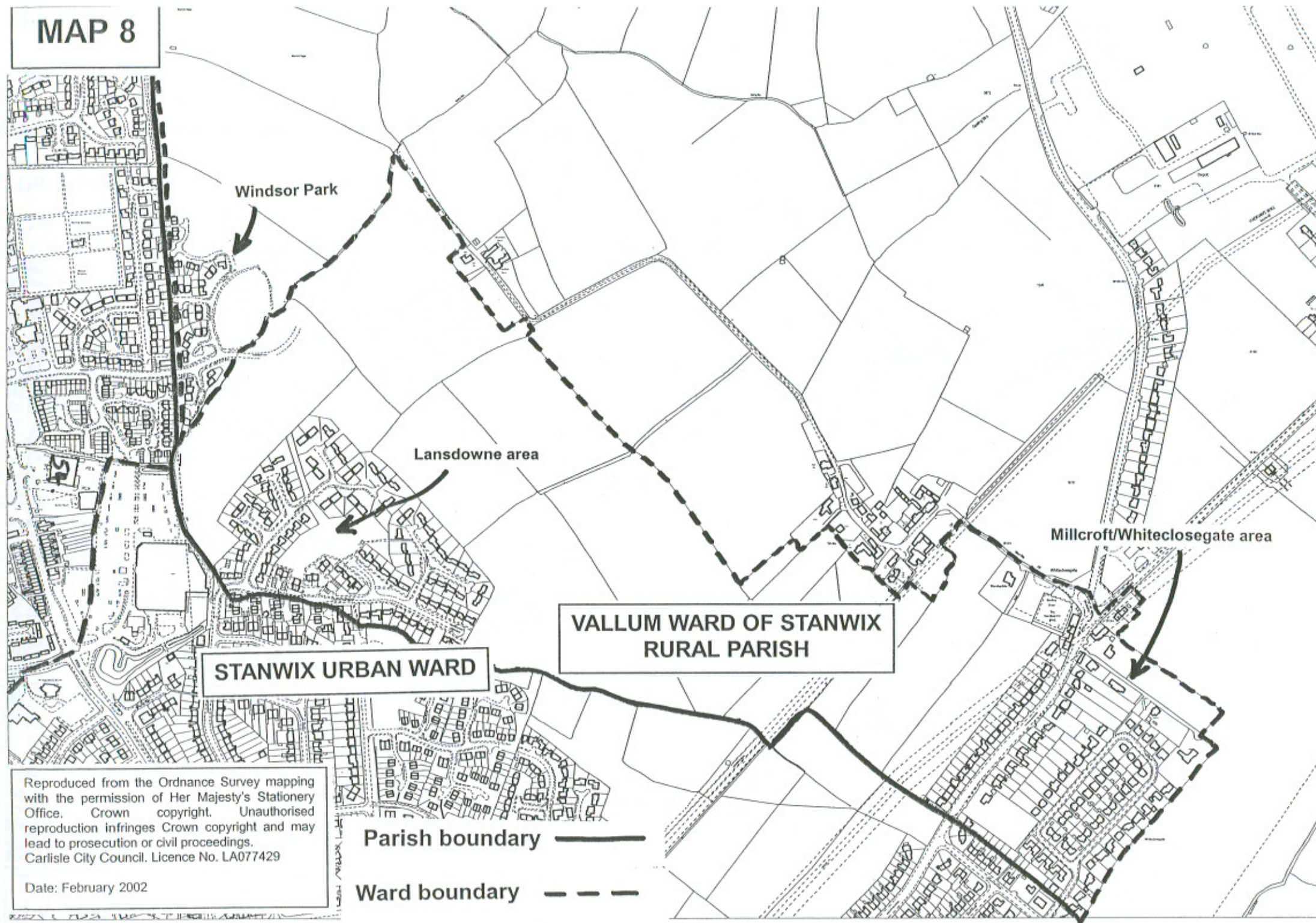

Reproduced from the Ordnance Survey mapping with the permission of Her Majesty's Stationery Office. Crown copyright. Unauthorised reproduction infringes Crown copyright and may lead to prosecution or civil proceedings. Carlisle City Council. Licence No. LA077429

Date: February 2002

MAP 9

Reproduced from the Ordnance Survey mapping with the permission of Her Majesty's Stationery Office. Crown copyright. Unauthorised reproduction infringes Crown copyright and may lead to prosecution or civil proceedings. Carlisle City Council. Licence No. LA077429

Date: February 2002

Area proposed to transfer from Stanwix Rural Ward to Belah Ward

Area proposed to transfer from Stanwix Urban Ward to Belah Ward

STANWIX RURAL PARISH AND WARD

STANWIX URBAN WARD

BELAH WARD

- Parish boundary —————
- Proposed Parish and Ward boundary (dotted line)
- Ward boundary - - - - -
- Proposed Ward boundary x x x x x

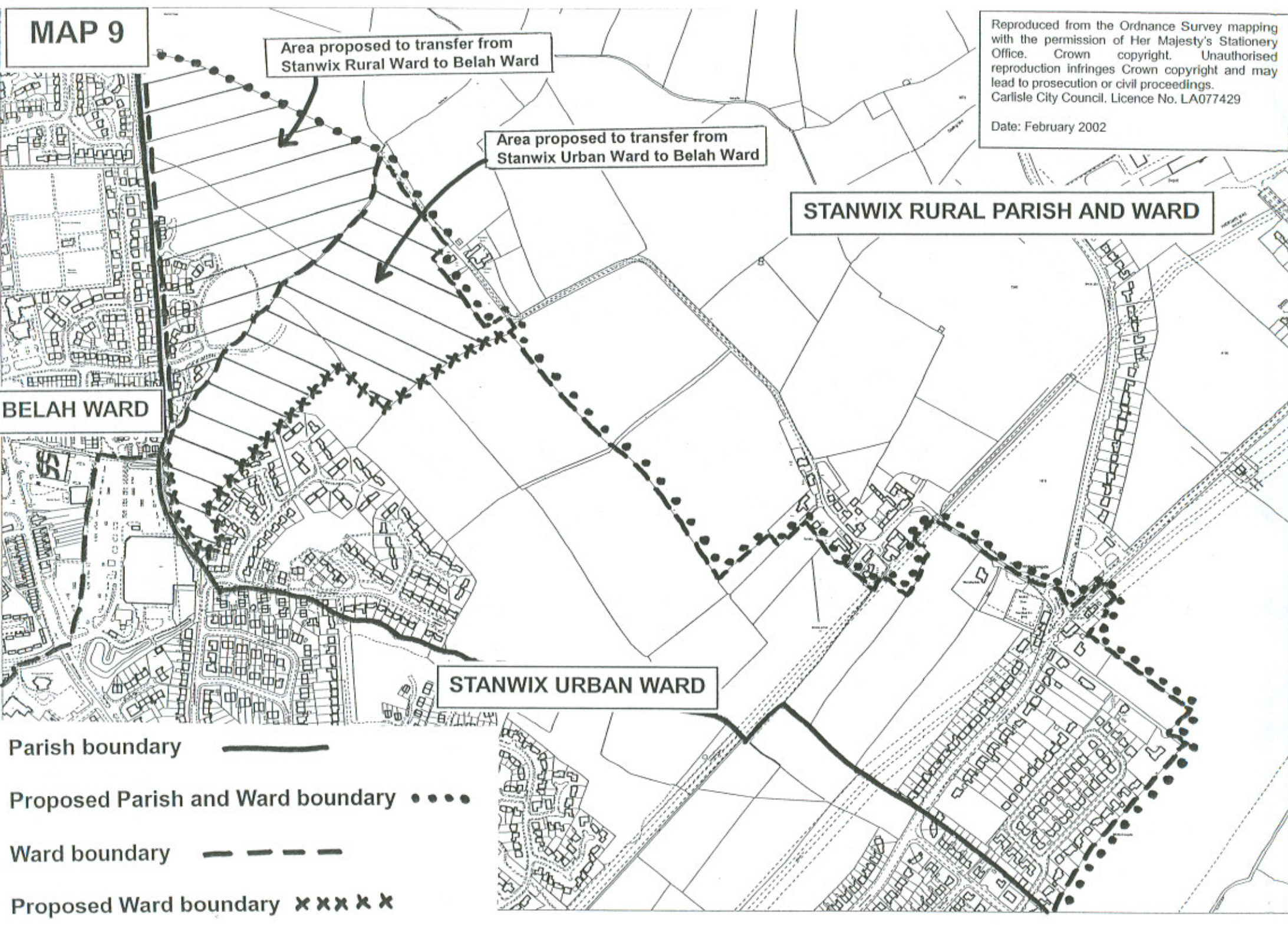

MAP 10

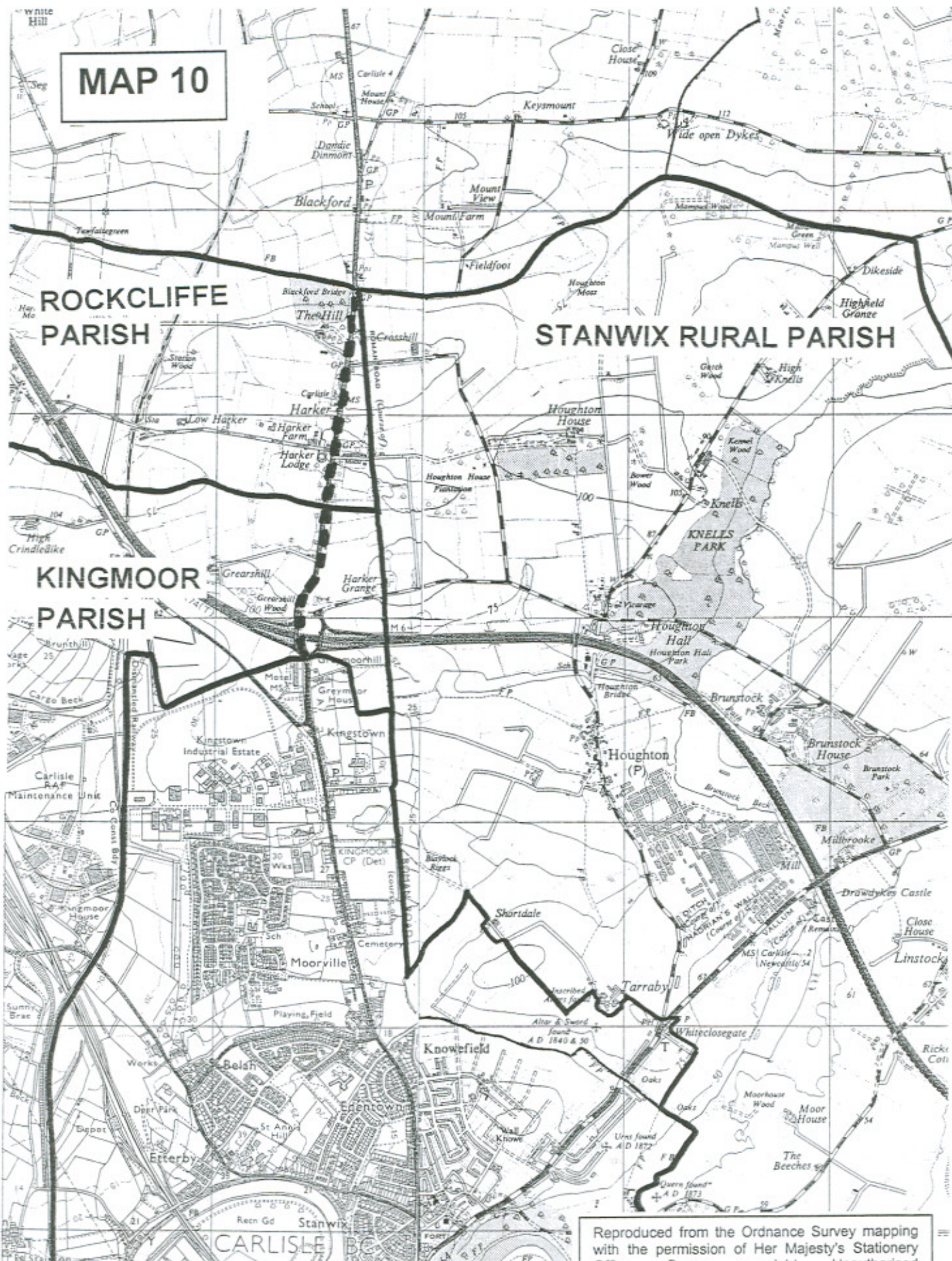

Revised boundary suggested - - -
by Stanwix Rural Parish Council
Parish boundary ———

Reproduced from the Ordnance Survey mapping with the permission of Her Majesty's Stationery Office. Crown copyright. Unauthorised reproduction infringes Crown copyright and may lead to prosecution or civil proceedings. Carlisle City Council. Licence No. LA077429

Date: February 2002

MAP 11

ROCKCLIFFE PARISH

(and Longtown and Rockcliffe Ward)

STANWIX RURAL PARISH

(and Stanwix Rural Ward)



Parish and Ward boundary

Proposed Parish and Ward boundary under
Draft Recommendations

Proposed Parish and Ward boundary under
Final Recommendations

57.

Reproduced from the Ordnance Survey mapping with the permission of Her Majesty's Stationery Office. Crown copyright. Unauthorised reproduction infringes Crown copyright and may lead to prosecution or civil proceedings. Carlisle City Council. Licence No. LA077429

Date: February 2002

MAP 12

Playing Fields

0021

STANWIX RURAL PARISH

0011

BELAH WARD

Detached part of
KINGMOOR Parish

0004

Newfieldhead

Blaylock Riggs

NEWFIELD DRIVE

Parish Boundary

58

Reproduced from the Ordnance Survey mapping with the permission of Her Majesty's Stationery Office. Crown copyright. Unauthorised reproduction infringes Crown copyright and may lead to prosecution or civil proceedings. Carlisle City Council. Licence No. LA077429

Date: February 2002

MAP 13

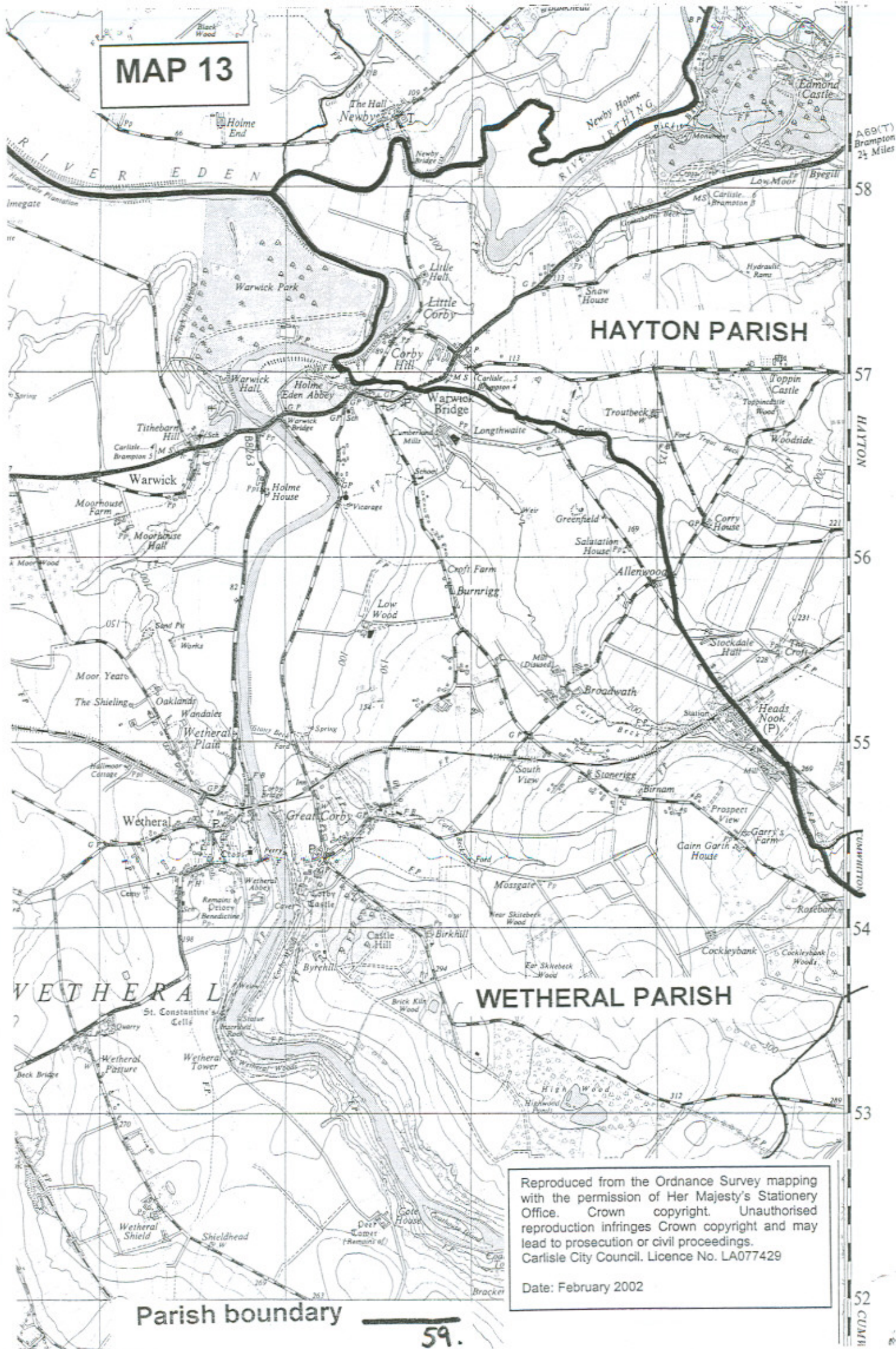

Reproduced from the Ordnance Survey mapping with the permission of Her Majesty's Stationery Office. Crown copyright. Unauthorised reproduction infringes Crown copyright and may lead to prosecution or civil proceedings. Carlisle City Council. Licence No. LA077429

Date: February 2002

MAP 14

KIRKLINTON PARISH

SCALEBY PARISH

Parish boundary

Humphries House Lonning

Reproduced from the Ordnance Survey mapping with the permission of Her Majesty's Stationery Office. Crown copyright. Unauthorised reproduction infringes Crown copyright and may lead to prosecution or civil proceedings. Carlisle City Council. Licence No. LA077429

Date: February 2002